



FOR LEASE

15,000 SF WAREHOUSE/PARKING GARAGE WITH OFFICE

ADDRESS: 39-20 30th Street
Long Island City, New York

DESCRIPTION: 39-20 30th Street – 15,000 sf two-level Warehouse/Garage with Office
**currently combined with additional 7,500 sf at 39-15 29th Street

LOCATION: 3 Blocks to Queensboro Plaza
1 Block to Newly Renovated 39th Avenue Subway (N or Q Lines)

FEATURES: 12' (lower level) & 17' (upper level) Ceiling Heights (see floor plan)
400 amps
Small Office Space
Three (3) New Bathrooms
Newly Painted Interior
New LED Ceiling Lighting
Drive in Entrances from 30th Streets (up ramp and down ramp)

ZONING: M1-3/R7X

POSSESSION: Upon Lease Signing

LEASE TERM: 5 Years (consideration of longer term with demo clause)

BASE RENT: \$300,000 Per Annum / \$25,000 p/month

CONTACT: WERWAISS & CO., INC. (Exclusive Agent)
22-15 43rd Avenue – Suite 300
Long Island City, NY 11101
(212) 983-0044
werwaiss.com
gwerwaiss@werwaiss.com



Upper Level



Lower Level



All information furnished regarding property for sale, rental or financing is from sourced deemed reliable. No representation is made as to the accuracy thereof and it is submitted subject to errors, omissions, change of price, rental or other conditions, prior sale, lease or financing, or withdrawal without notice. BROKERS PROTECTED BY AGREEMENT ON FILE.

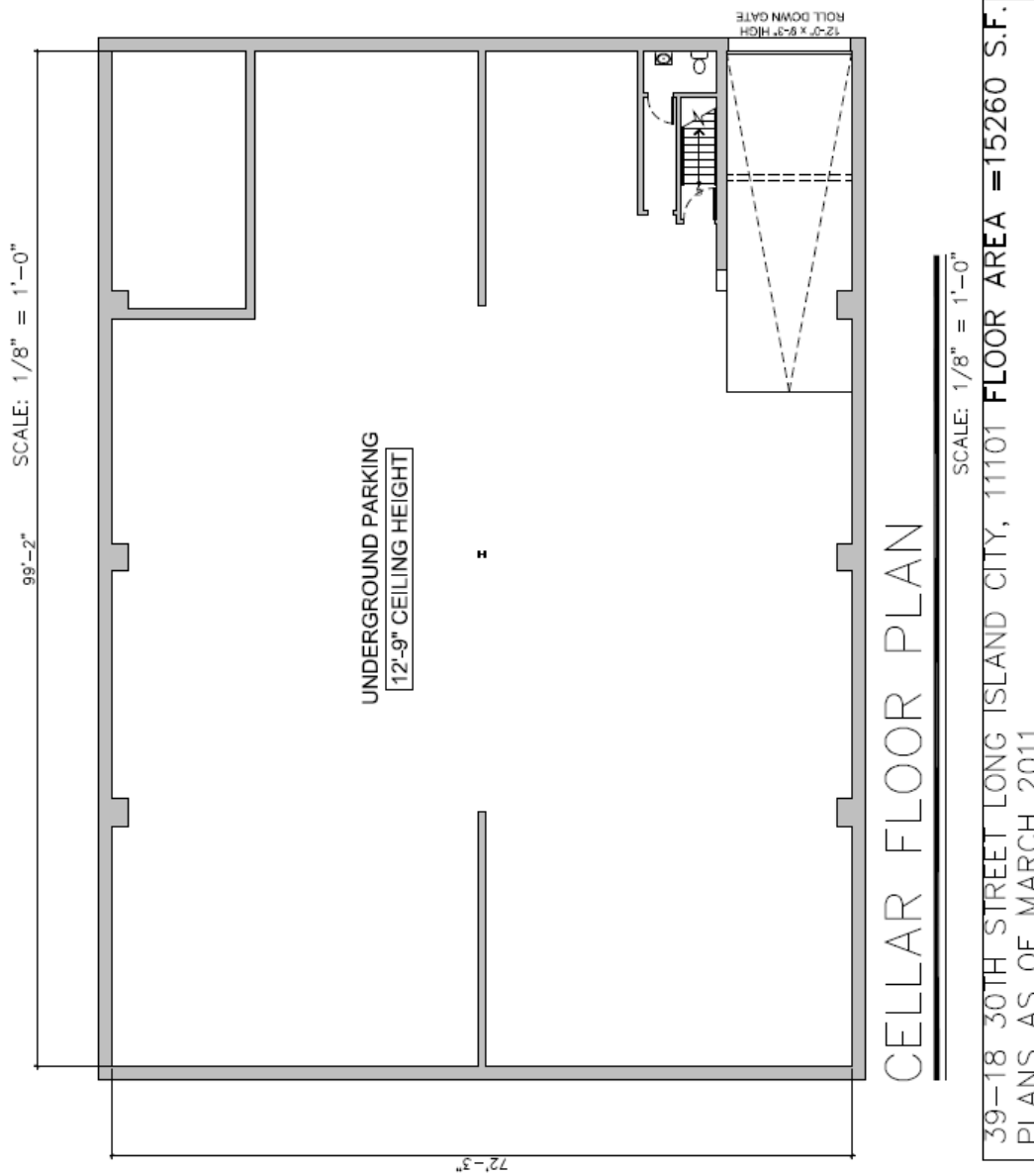

All information furnished regarding property for sale, rental or financing is from sourced deemed reliable. No representation is made as to the accuracy thereof and it is submitted subject to errors, omissions, change of price, rental or other conditions, prior sale, lease or financing, or withdrawal without notice. BROKERS PROTECTED BY AGREEMENT ON FILE.

1/8/21